

SEAS RECYCLING LOCATION MAP

**ALL ALKALINE BATTERIES*

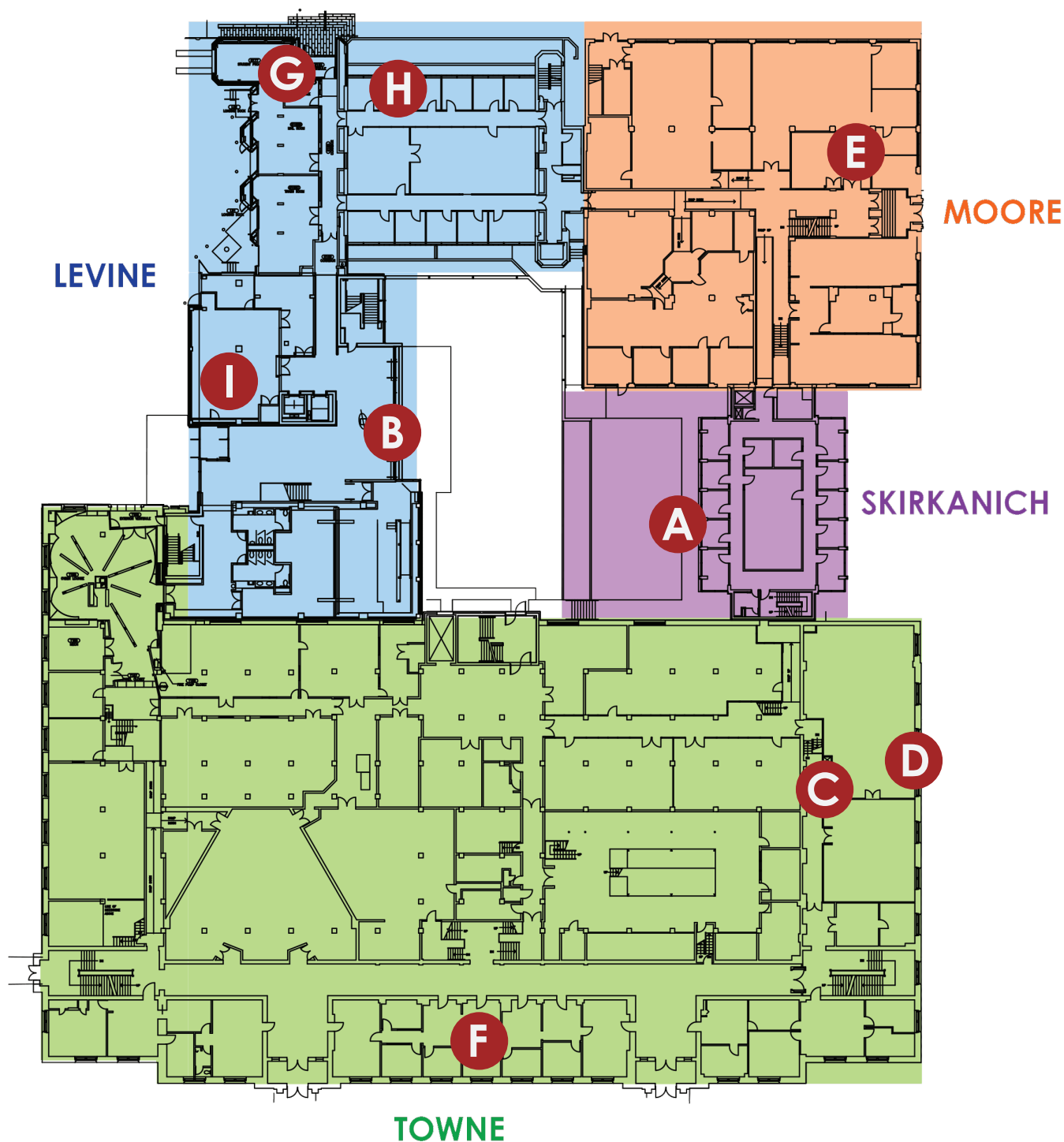

- A** 240 SKIRKANICH, BE OFFICE
- C** 226A TOWNE, MEAM OFFICE
- E** 203 MOORE, ESE OFFICE
- G** 459 LEVINE, CIS OFFICE
- I** 403 LEVINE, GRASP LAB

- B** 502 LEVINE, CIS OFFICE
- D** B13 TOWNE, EOS OFFICE
- F** 311A TOWNE, CBE OFFICE
- H** 168 LEVINE, CETS OFFICE

LRSM: 200 LRSM, MSE OFFICE
SINGH CENTER: 220 NANO

*Locations also in laboratories throughout SEAS complex

*See [EHR](http://www.ehrs.upenn.edu/)s website for more details (<http://www.ehrs.upenn.edu/>)